

EXPECT THE BEST

Studiomaster

AREA-Series speaker column

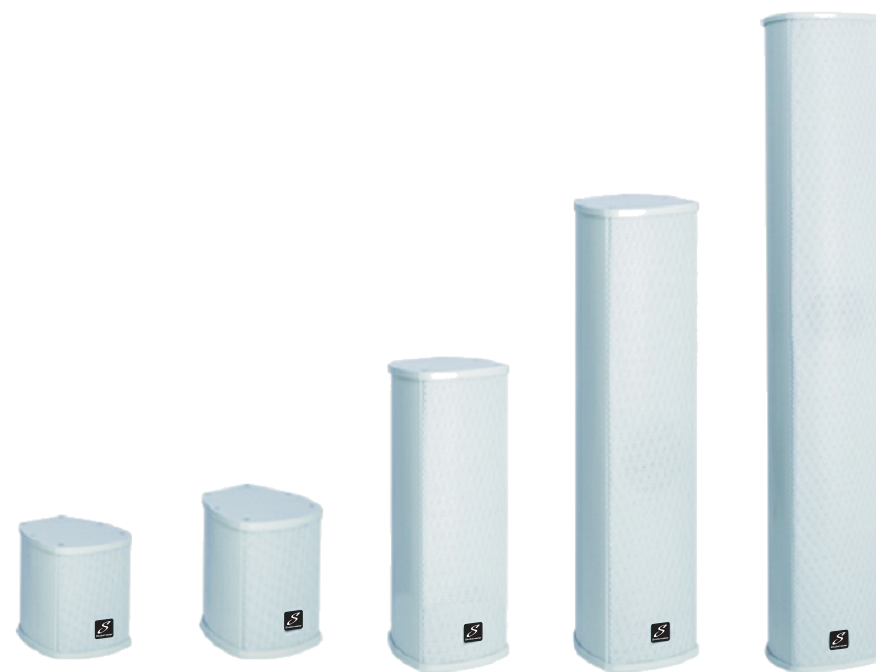

Studiomaster

**Unit 11,
Torc:MK
Chippenham Drive
Kingston
Milton Keynes
MK10 0BZ
United Kingdom.
Tel: +44(0)1908 281072 email: enquiries@studiomaster.com**

www.studiomaster.com

**USER
GUIDE**

GD202210145

070404480

10. Troubleshooting

Problem	What to do
Power light does not go on	Check if the power cord is connected properly and the power supply is normal? Is the power switch switched on? Is the amplifier fuse burnt out?
No sound	Is the system properly connected? Is the power on? Is the signal input normal?
Distortion	Check if the signal is too large? Is the limiter light on? If so, reduce the input signal level.
Abnormal sound	Is the system cable properly connected? Is the signal input correct? Are digital audio processor parameters set properly?
Insufficient sound pressure level	Is the system properly connected? Is the volume knob in the right position? Is the mixer output knob in proper position?

Note: If you still cannot solve the problem after following the above steps, please contact our distributor.

11. Package list

After unpacking, check to see if anything is missing. If so, please contact our distributor.

Speaker	1pcs
User manual	1pcs
Certification	1pcs
Maintenance card	1pcs
Expansion screws	4pcs
Tapping screw	4pcs
Wall mount	1pcs
Sealing cover (outdoor series – waterproof)	1pcs

IMPORTANT SAFETY SYMBOLS



The symbol is used to indicate that some hazardous live terminals are involved within this apparatus, even under the normal operating conditions, which may be sufficient to constitute the risk of electric shock or death.



The symbol is used in the service documentation to indicate that specific component shall be replaced only by the component specified in that documentation for safety reasons.



Protective grounding terminal



Alternating current/voltage



Hazardous live terminal

ON: Denotes the apparatus is turned on

OFF: Denotes the apparatus is turned off.

WARNING: Describes precautions that should be observed to prevent the danger of injury or death to the operator.

CAUTION: Describes precautions that should be observed to prevent danger of the apparatus.

• Ventilation

Do not block ventilation opening, failure to do so could result in fire. Please install according to the manufacturer's instructions.

• Object and Liquid Entry

Objects do not fall into and liquids are not spilled into the inside of the apparatus for safety.

• Power Cord and Plug

Protect the power cord from being walked on or pinched particularly at plugs, convenience receptacles, and the point where they exit from the apparatus. Do not defeat the safety purpose of the polarized or grounding-type plug. A polarized plug has two blades with one wider than the other. A grounding type plug has two blades and a third grounding prong. The wide blade or the third prong is provided for your safety. If the provided plug does not fit into your outlet, refer to electrician for replacement.

• Power Supply

The apparatus should be connected to the power supply only of the type as marked on the apparatus or described in the manual. Failure to do could result in damage to the product and possibly the user. Unplug this apparatus during lightning storms or when unused for long periods of time.



Use only with the cart, stand, tripod, bracket, or table specified by the manufacturer, or sold with the apparatus. When a cart is used, use caution when moving the cart/apparatus combination to avoid injury from tip-over.

IMPORTANT SAFETY INSTRUCTIONS

• Read these instructions.

• Keep these instructions.

• Heed all warning.

• Follow all instructions.

• Water & Moisture

The apparatus should be protected from moisture and rain, can not used near water, for example: near bathtub, kitchen sink or a swimming pool, etc.

• Heat

The apparatus should be located away from heat sources such as radiators, stoves or other appliances that

• Fuse

To prevent the risk of fire and damaging the unit, please use only of the recommended fuse type as described in the manual. Before replacing the fuse, make sure the unit turned off and disconnected from the AC outlet.

• Electrical Connection

Improper electrical wiring may invalidate the product warranty.

• Cleaning

Clean only with a dry cloth. Do not use any solvents such as benzol or alcohol.

• Servicing

Do not implement any servicing other than those means described in the manual. Refer all servicing to qualified service personnel only.

• When this product is powered on and in working state, do not connect or disconnect power supply, speaker or height adjustment column, otherwise it can cause the device to burn out.

1. Product introduction

Dear Customer, thank you for purchasing the latest AREA-Series all-weather column speaker from Studiomaster. AREA-Series is composed of several high quality 3" neodymium magnetic full-range speakers arranged tightly. It features wide frequency response, high definition, wide horizontal coverage angle and long -throw distance. Compared to professional speakers with the same maximum sound pressure level, they are smaller in size, lighter in weight and easier to carry. Aluminum alloy enclosure, with its slim and compact shape, can merge perfectly with the building environment to create a beautiful and comfortable listening space. Fully waterproof structure, dustproof, waterproof grade: IP54. 4/8 plug-in terminal sockets, 2 internal parallel connections, dedicated PG waterproof socket signal output.

3" Full-range speaker, glass fiber diaphragm, NeFeB magnetic circuit, high sensitivity, light weight.

With professional speaker wall mount, you can rotate a certain angle according to the requirements of the sound amplification environment to achieve satisfactory sound amplification effect.

AREA series of column speakers include: AREA 31, AREA 32, AREA 34, AREA 38, AREA 312.

Two color-black and white for your choice.

Applications: Stations, airports, shopping malls, exhibition halls, conference rooms, halls, churches and other sound amplification occasions with high requirements for intelligibility and background music quality, can also be used in outdoor applications such as theme parks.

2. Safety Warnings and Precautions:

In order to avoid accidental damage to you and others around you and to cause accidental damage to your equipment or property, it is important to observe the following considerations, which include, but are not limited to the following.

- * The product has been properly packed before leaving the factory to ensure safe transportation. Please carefully check if any accidental damage caused by transportation or other reasons occurs before opening the package for the first time.

- *The device can produce high sound pressure over 90dB, which may cause permanent hearing damage. Note to select an appropriate volume setting.

- *When hanging this speaker, professional builders must be asked to use safe brackets to mount it.

- *Avoid acoustic feedback when using to avoid damaging your audio equipment.

- *Do not plug and unplug the signal cable when the power amplifier is switched on, in order to avoid signal shock damage to your audio equipment.

- *Please do not remove the metal mesh of the protective speaker at will to avoid damage to internal parts and irreparable damage.



Multi-function recording mixer

CLUB XS 5+/CLUB XS 6+/CLUB XS 8+/CLUB XS 10+/CLUB XS 12+

There are 6/8/10/12 input channels for CLUB XS+ model. 6-ch inputs with 2 mic channels, 8-ch inputs with 4 mic channels, 10-ch inputs with 6 mic channels, and 12-ch inputs with 8 mic channels. All models have 2 stereo input channels. The input channels have 3 EQs, 2 AUX, balanced mic/line connectors, compression control and a practical mute switch, except that only 2 EQs of the stereo channel have no compression. The main output is a balanced XLR with additional Jack output for auxiliary and control rooms and RCA phono recording/playback devices.

The USB/SD card is used for stereo recording/playback, making CLUB XS+ the ideal home recording device, and also providing background music for your live performance. The design also adds practicality to the product - a built-in MP3 player that makes it easy for you to perform live.

CLUB XS+ series products also have 16 effects of DSP. The CLUB XS+ series also features a +48V phantom power supply for all microphone channels, a high quality 60mm smooth fader, and a high efficiency, low noise switching power supply.

3. Mixer

digiLive 16



Product introduction

Studiomaster digiLive mixer—16 channels, motorised faders, large touch screen, USB port. Every function you need from on a live mixing is available. Digilive is a brainchild of years of research and development experience by Studiomaster and the latest technology to make it easy for you to tune in.

Although ultra compact, digiLive is designed with the expertise of a digital mixer. All settings can be called, including the most important motorised fader. You can also use the WiFi remote control mixer anywhere in the scene.

There are 12 mic/line inputs and 2 stereo inputs, all of which can be assigned to 8 balanced outputs via 16-way bus, connected to a professional digital interface--AES/EBU, SPDIF and two USB ports. The 1024x600 touch screen makes the operation simple and intuitive. In fact, users can take digiLive out of the package without reading 100 pages of instructions.

Studio-level sound, multiple effects, and adequate dynamic processing make digiLive easy to tune.

3.Product features

AREA 31 compact passive full-range near-field speaker:

- >Integrated metal shell, complete set of mould processing, easy assembly and convenient operation;
- >4-pin plug-in terminal socket, 2-way internal parallel connection, dedicated PG waterproof socket signal output;
- >1X3"full-range speaker, glass fiber diaphragm, NeFeB magnetic circuit, high sensitivity, light weight;
- > Fixed-resistance passive speaker design, you can use multiple units, series-parallel connection according to the site amplification requirements.
- >Fully waterproof structure design, dust-proof, water-proof grade: IP54;
- >With professional speaker wall mount, you can rotate a certain angle according to the requirements of the applications to achieve satisfactory sound amplification effect.

AREA 32 compact passive full-range near-field speaker:

- >Integrated metal shell, complete set of mould processing, easy assembly and convenient operation;
- >4-pin plug-in terminal socket, 2-way internal parallel connection, dedicated PG waterproof socket signal output;
- >2X3"full-range speaker, glass fiber diaphragm, NeFeB magnetic circuit, high sensitivity, light weight;
- > Fixed-resistance passive speaker design, you can use multiple units, series-parallel connection according to the site amplification requirements.
- >Fully waterproof structure design, dust-proof, water-proof grade: IP54;
- >With professional speaker wall mount, you can rotate a certain angle according to the requirements of the applications to achieve satisfactory sound amplification effect.

AREA 34 line array column speaker:

- >Integrated metal shell, complete set of mould processing, easy assembly and convenient operation;
- >8-pin plug-in terminal socket, 2-way internal parallel connection, dedicated PG waterproof socket signal output;
- >4X3"full-range speaker, glass fiber diaphragm, NeFeB magnetic circuit, high sensitivity, light weight;
- > Fixed-resistance passive speaker design, you can use multiple units, series-parallel connection according to the site amplification requirements.
- >Fully waterproof structure design, dust-proof, water-proof grade: IP54;
- >With professional speaker wall mount, you can rotate a certain angle according to the requirements of the applications to achieve satisfactory sound amplification effect.

AREA 38 column speaker:

- >Integrated metal shell, complete set of mould processing, easy assembly and convenient operation;
- >8-pin plug-in terminal socket, 2-way internal parallel connection, dedicated PG waterproof socket signal output;
- >8X3"full-range speaker glass fiber diaphragm, NeFeB magnetic circuit, high sensitivity, light weight;
- > Fixed-resistance passive speaker design, you can use multiple units, series-parallel connection according to the site amplification requirements.
- > Fully waterproof structure design, dust-proof, water-proof grade: IP54;
- >With professional speaker wall mount, you can rotate a certain angle according to the requirements of the applications to achieve satisfactory sound amplification effect.

AREA 312 column speaker:

- >Integrated metal shell, complete set of mould processing, easy assembly and convenient operation;
- >8-pin plug-in terminal socket, 2-way internal parallel connection, dedicated PG waterproof socket signal output;
- > 12X3"full-range speaker, glass fiber diaphragm, NeFeB magnetic circuit, high sensitivity, light weight;
- > Fixed-resistance passive speaker design, you can use multiple units, series-parallel connection according to the site amplification requirements.
- >Fully waterproof structure design, dust-proof, water-proof grade: IP54;
- >With professional speaker wall mount, you can rotate a certain angle according to the requirements of the applications to achieve satisfactory sound amplification effect.

2.Digital audio processor

AC36II/AC48II



System Specification	Frequency Response	20Hz~20kHz, $\pm 0.3\text{dB}$
	Dynamic Range	$>110\text{ dBu}$
	Distortion (THD)	$\leq 0.01\%$ at 1kHz (0dBu)
	Cross-talk	$>70\text{dBu}$ 20Hz~20kHz
	C.M.R.R	$>75\text{dBu}$ 1kHz
Input Section	Type	Balanced XLR
	Max. Input Level	+15dBu
	Impedance	$\geq 8\text{k}\Omega$
Output Section	Type	Balanced XLR
	Max. Output Level	+15dBu
	Impedance	$\leq 50\Omega$
Digital Processing	24-bit sigma - delta A/D, D/A convert	
	32 bit DSP, 96kHz Sampling Rates	
Display	Lattice screen display current Parameters and all Setting	
Power Supply	AC~95V-250V 50/60Hz	
Dimension(LxWxH)	48.2x20.5x4.4CM	
Weight	2.3kg	

You can choose the following equipment to match the actual needs of your use:

1.Amplifier



Model	HX2-300	HX2-500	HX2-700	HX2-900	HX4-600	HX4-1000	HX4-1400	HX4-1800
Rated Output Power(THD+N=1%, 1kHz continue sine wave, all channel driving)	8Ω/Stereo	2X150W	2X250W	2X350W	2X450W	4X150W	4X250W	4X350W
	4Ω/Stereo	2X255W	2X425W	2X595W	2X765W	4X255W	4X425W	4X595W
	2Ω/Stereo*	2X435W	2X725W	2X1015W	2X1300W	4X435W	4X725W	4X1015W
	16Ω/Bridge	1X300W	1X500W	1X700W	1X900W	2X300W	2X500W	2X700W
	8Ω/Bridge	1X510W	1X850W	1X1190W	1X1530W	2X510W	2X850W	2X1190W
	4Ω/Bridge*	1X870W	1X1450W	1X2030W	1X2600W	2X870W	2X1450W	2X2030W
Output RMS voltage(THD+N=1%, 1kHz)	34.6V	44.7V	52.9V	60.0V	34.6V	44.7V	52.9V	60.0V
Slew rate(1kHz, low-pass filter bypassed)	50V/us							



Model	QX2-6000	QX4-8000	QX4-6000	QX2-4000	QX2-3000
Rated Output Power(THD+N=1%, 1kHz continue sine wave, all channel driving)	8Ω/Stereo	2X3000W	4X2000W	4X1500W	2X2000W
	4Ω/Stereo	2X5100W	4X3400W	4X2550W	2X3400W
	2Ω/Stereo*	2X7140W	4X4760W	4X3570W	2X4760W
	16Ω/Bridge	1X6000W	2X4000W	2X3000W	1X4000W
	8Ω/Bridge	1X10200W	2X6800W	2X5100W	1X6800W
	4Ω/Bridge*	1X14280W	2X9520W	2X7140W	1X9520W
Output RMS voltage(THD+N=1%, 1kHz)	154.9V	126.5V	109.5V	126.5V	109.5V
Slew rate(1kHz, low-pass filter bypassed)	50V/us				

4.Function and control

AREA 31/AREA 32 Compact passive full-range near-field speaker:
4 pin plug-in terminal: left to right'-+-' , which has two parallel connections. You only need to connect one way for signal input, and link the other way to next speaker . Refer to the figure below.

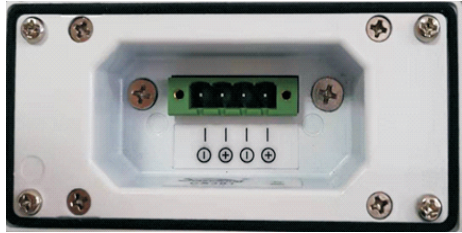

figure 1

AREA 34/AREA 38//AREA 312 column speaker:
8 pin plug-in terminals: 4 terminals on the left are left to right'-+', and there are two parallel connections inside. You only need to connect one way for signal input, and link the other way to next speaker. Refer to the figure below.



figure 2

5. WIRING

. For 1/4" phone jack

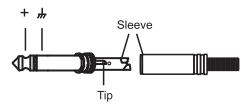

1/4" TS jack
Unbalanced input/output

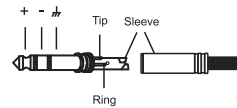

1/4" TRS jack
Balanced input/output

. For XLR

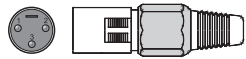

XLR(male)
pin2=Hot, pin3=Cold, pin1=Ground



XLR(male)
pin2=Hot, pin3=Cold, pin1=Ground

. For SPEAKON

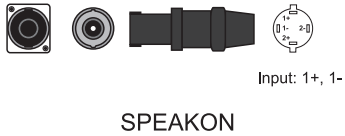

SPEAKON

. For RCA

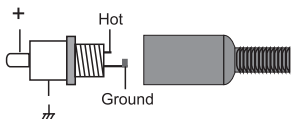
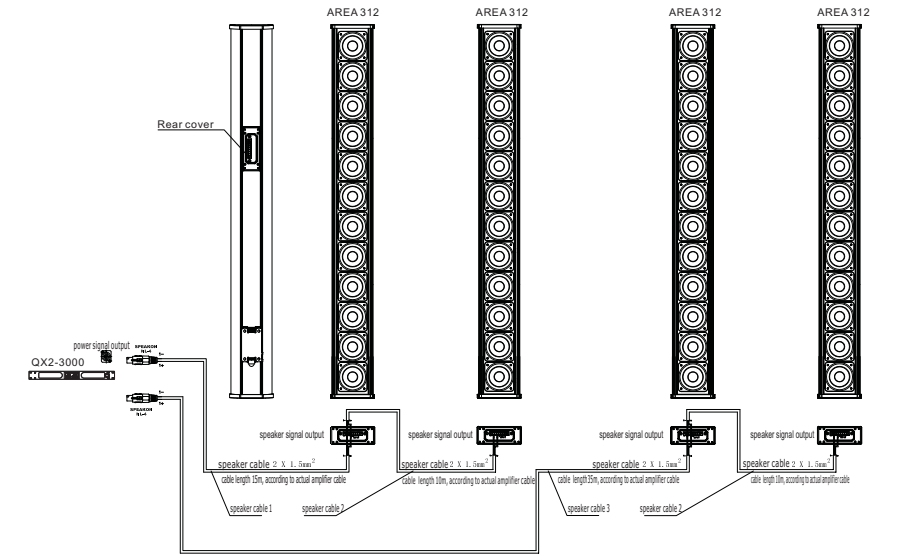
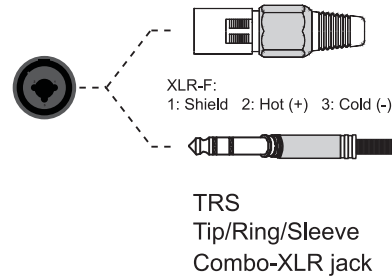
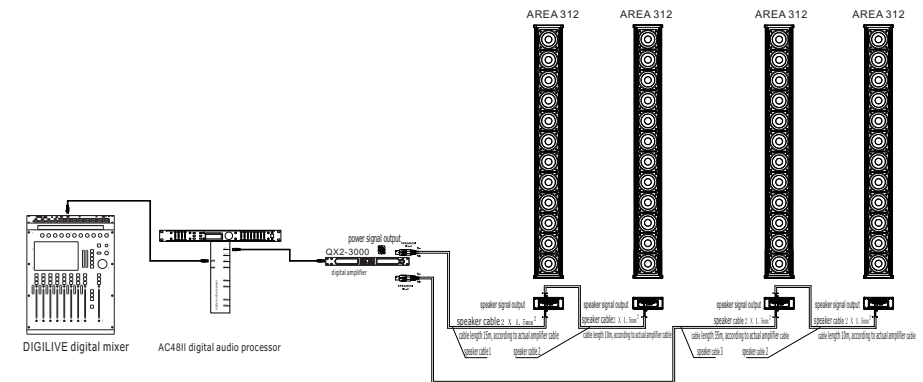

figure 3

. For COMBO



(Figure 5 speaker system configuration)



(Figure 6 speaker system configuration)

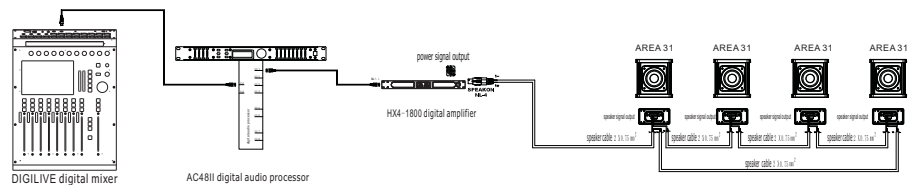

〈Figure 3 speaker system configuration〉

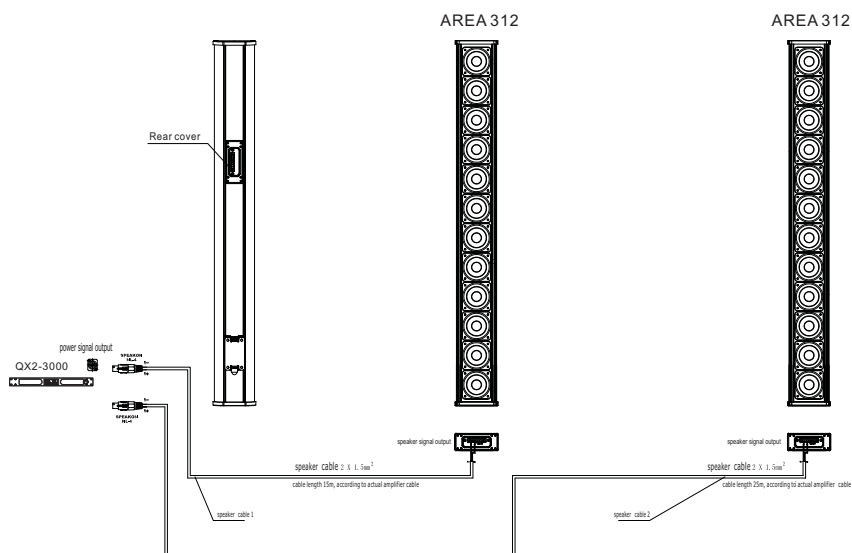

〈Figure 4 speaker system configuration〉

6. Installation

AREA 31/AREA 32 Compact passive full-range near-field speaker:

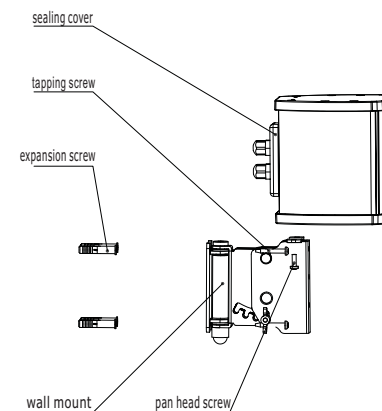

figure 4

1. Use a cross screwdriver to assemble the attached 2-M4 pan-head screw and external teeth lock washer and flat washer into place between the speaker wall mount and the bottom of the column.
2. Punch 4 holes at the places to be installed on the wall with impact drill and insert 4 additional expansion screws into the holes.
3. Lock the column speaker with 4 tapping screws attached. Turn the speaker wall mount from left to right during assembly to facilitate the installation of column.
4. Adjust the vertical cover angle of the column according to the actual needs, and select the appropriate gear for the speaker wall mount to lock the butterfly nuts of the speaker wall mount.

The installation of column speaker AREA 34/AREA 38/AREA 312 is basically the same, except that the wall mounts are installed on the back of the columns. As shown in the following figure

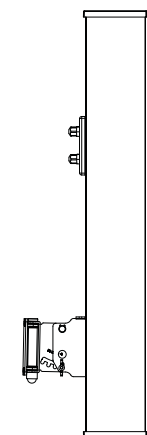
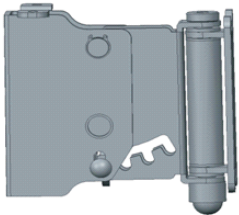
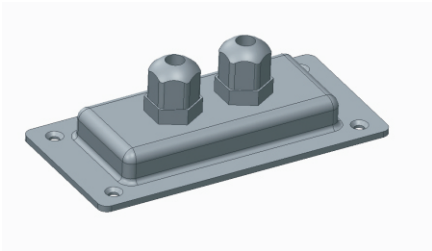

figure 5

7.Accessories



Speaker wall mount



Sealing cover

figure 8

8.Specification

Model	AREA 31
Type	1x3" compact passive full-range near-field speaker
Frequency response(-10dB)	130Hz~20kHz
Rated power	30W(continue) , 120W(peak)
Max SPL(@1m)	108 dB (peak)
Coverage(HxV)	100°x100°
Transducer	1x3"/φ20mm voice coil/30W/8Ω
Sensitivity	87dB
Nominal impedance	8Ω
Connector	1xPHOENIX (4P)
Dimension (W*H*D)	118*122*121mm
Net weight	1.1kg

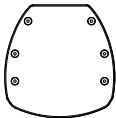
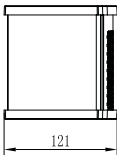
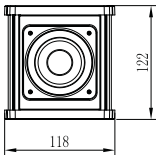
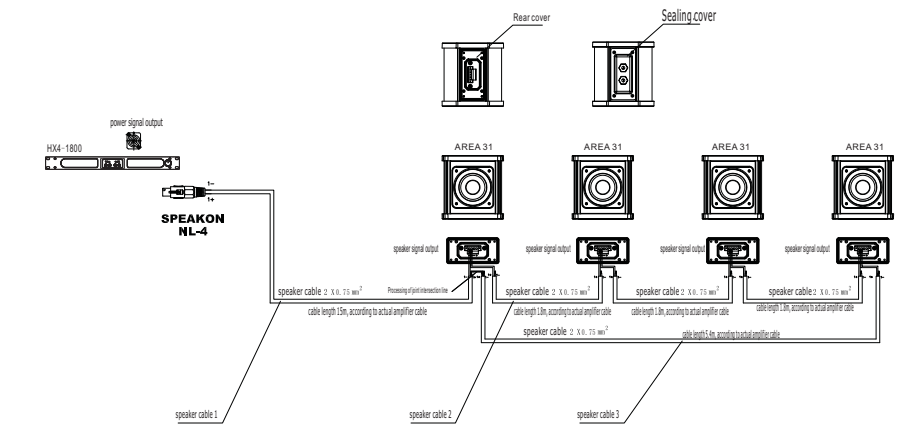
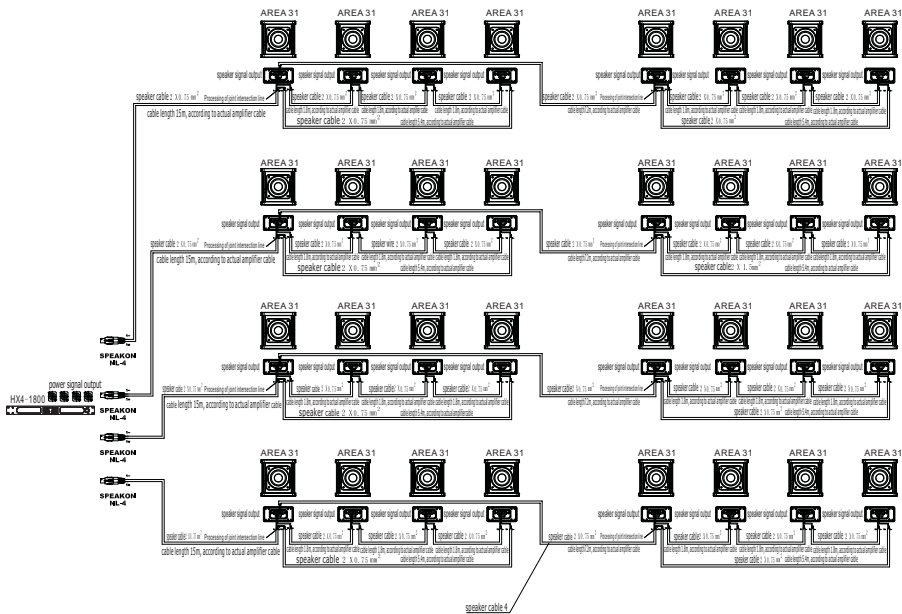

figure 9

9. System connection



(Figure 1 speaker system configuration)



(Figure 2 speaker system configuration)

Model	AREA 312
Type	12x3" passive full-range column speaker
Frequency response (-10dB)	130Hz-20kHz
Rated power	360W (continue), 1440W (peak)
Max SPL (@1m)	130 dB (peak)
Coverage (HxV)	100°x20°
Transducer	12x3"/φ20mm voice coil/30W/8Ω
Sensitivity	98dB
Nominal impedance	12Ω
Connector	1xPHOENIX (8P)
Dimension (W*H*D)	118*1006*121mm
Net weight	6.9kg

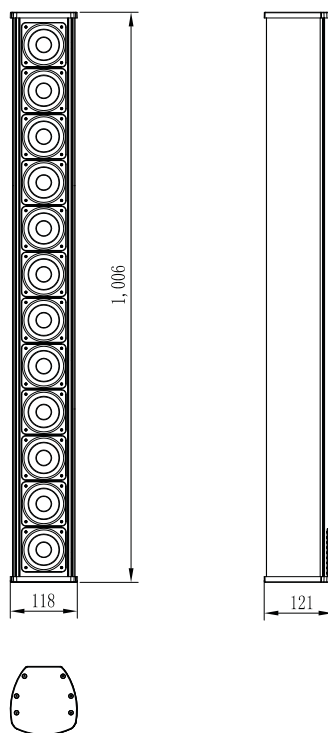

Note:

1. Frequency response (-10dB) is based on the measured values in the anechoic chamber and in the half-open space.
2. Coverage angle (H x V) is based on the -6dB test value in the 1k-4kHz frequency range.

Model	AREA 32
Type	2x3" compact passive full-range near-field speaker
Frequency response (-10dB)	130Hz-20kHz
Rated power	60W (continue), 240W (peak)
Max SPL (@1m)	114 dB (peak)
Coverage (HxV)	100°x40°
Transducer	2x3"/φ20mm voice coil/30W/4Ω
Sensitivity	90dB
Nominal impedance	8Ω
Connector	1xPHOENIX (4P)
Dimension (W*H*D)	118*190*121mm
Net weight	1.6kg

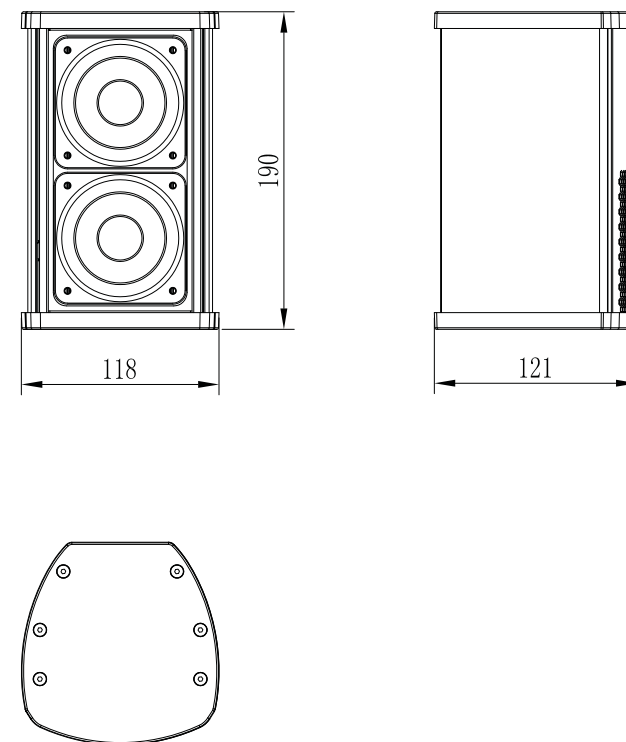

Model	AREA 34
Type	4x3" passive full-range column speaker
Frequency response(-10dB)	130Hz-20kHz
Rated power	120W(continue), 480W(peak)
Max SPL (@1m)	120 dB (peak)
Coverage (HxV)	100°x30°
Transducer	4x3"/ ϕ 20mm voice coil/30W/8 Ω
Sensitivity	93dB
Nominal impedance	8 Ω
Connector	1xPHOENIX (8P)
Dimension (W*H*D)	118*400*121mm
Net weight	2.9kg

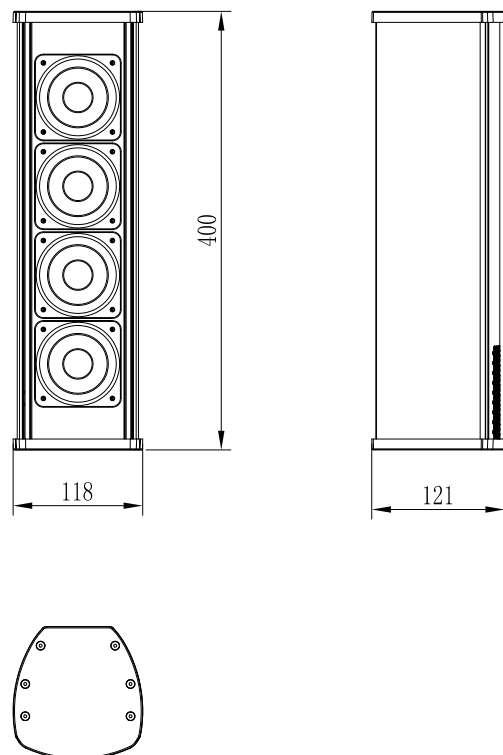

Model	AREA 38
Type	8x3" passive full-range column speaker
Frequency response(-10dB)	130Hz-20kHz
Rated power	240W(continue), 960W(peak)
Max SPL (@1m)	126 dB (peak)
Coverage (HxV)	100°x20°
Transducer	8x3"/ ϕ 20mm voice coil/30W/4 Ω
Sensitivity	96dB
Nominal impedance	8 Ω
Connector	1xPHOENIX (8P)
Dimension (W*H*D)	118*682*121mm
Net weight	4.9kg

